



ELLWEE

QUICK START GUIDE



ELLWEE SINGLE

SEATED ELECTRIC

GOLF & RESORT VEHICLE



This publication is subject to change without any notification, this publication supersedes and replaces all information previously supplied! Released 2021-04-08.

1. INTRODUCTION

Congratulations to your new ELLWEE!

Below follows a guide so that you can get your ELLWEE ready for the golf course or any other suited usage. Before driving, please locate the safety labels and familiarize yourself with all of them before proceeding with operating the vehicle.

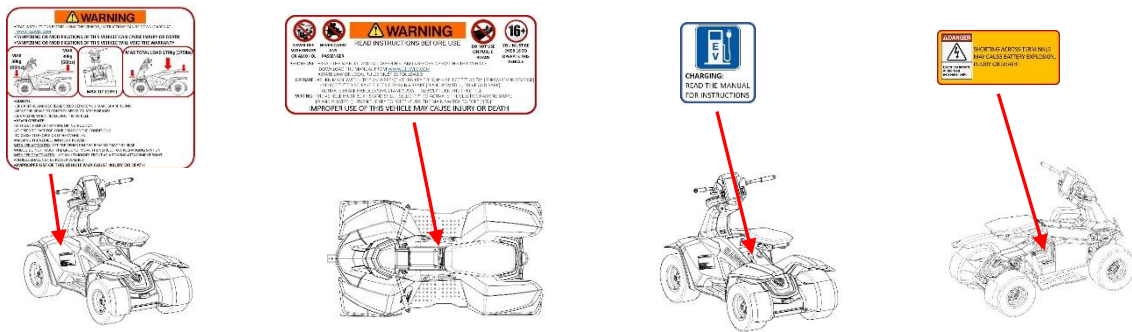

These safety labels inform and warn the user about remaining risks, i.e. Those which could not be eliminated or sufficiently reduced by design and against which technical safety precautions are not - or are not completely - effective.

Read all safety instruction in operators manual. Can be downloaded at www.ellwee.com.

2. INSTALLATION

2.1. OPEN THE BOX AND TAKE OUT VEHICLE

Vehicle is delivered on a wooden pallet with cardboard box on top. Follow the steps below when opening the box and taking out the vehicle.

1. Cut the straps around the box.
2. Fold sides and place behind pallet as picture shows.
3. Open the two straps that fixates the two wheels.
4. Find vehicle key in Ziploc bag fixed on pallet.
5. Turn main switch to ON, insert key and turn one click to start vehicle.
6. Release the electronic parking brake by pushing the D-switch.
7. Now the vehicle can be taken down from the pallet, take it backwards on the pallet, use sides as a ramp.
8. Dispose cardboard box and wooden pallet at the nearest recycling centre.



2.2. INSTALLATION OF PARTS

Two parts on the vehicle are not assembled during transport and needs to be assembled before you start using your vehicle. Follow the instructions below to make a proper assembly.

Tools needed:

- Torx No.20
- Wrench, size 7
- Hex key No. 5
- Hex key No. 6
- Nippers or scissors



2.2.1 IP UPPER

1. Remove IP Upper from its transportation place on the saddle or from the box.
2. Place IP Upper on IP Lower, fixated on the handle bar.
3. Take four screws (M4x12) and two locking nuts from the Ziploc bag.
4. Enter two front screws and then fixate two rear screws with nuts.
5. Tighten the two front screws.

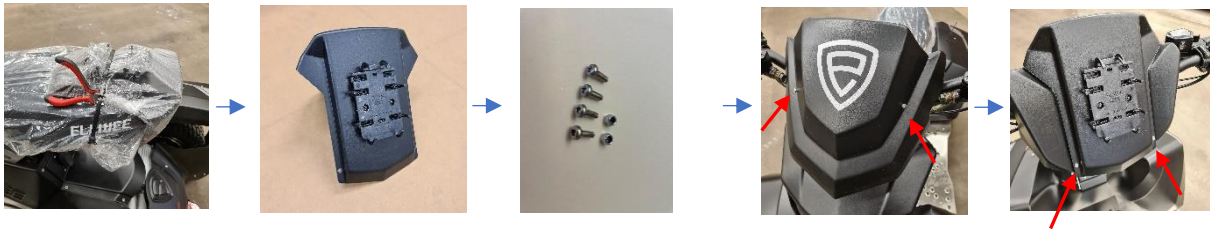

2.2.2 MULTIFIXATION BRACKET FRONT

1. Loosen bracket from the wooden pallet.
2. Take two screws from the Ziploc bag.
3. Enter top screw so that the bracket is in correct location.
4. Enter second screw from underneath, this needs to go through a hole in the plastic and steel frame before it is fixated in the weld nut located on the bracket. Tighten firmly.
5. Tighten the first screw.

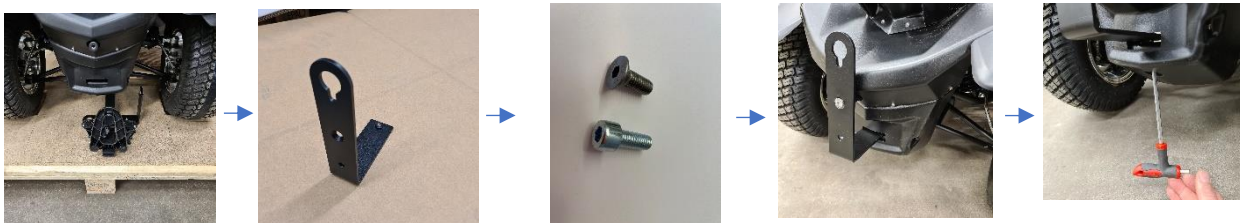

NOW YOUR VEHICLE IS READY FOR USAGE



3 HANDLING OF VEHICLE

3.1. IMPORTANT INSTRUCTIONS BEFORE USING THE VEHICLE FOR THE FIRST TIME

Attention: These steps must be followed before using the vehicle for the first time, failure to do so may inflict serious damage to vehicle and/or person driving it.

1. Read all safety instructions.
2. Make sure that the wheel nuts are firmly tightened.
3. Check that the brakes are functioning.

3.2. DRIVING INSTRUCTIONS

3.2.1 STARTING THE VEHICLE

1. Read the safety labels located on the vehicle.
2. Study and understand controls.
3. Make sure any load is secured.
4. Turn on the main switch.
5. Make sure that the driver is seated and secured.
6. Make sure wheels are turned in desired direction and that nothing is obstructing vehicles path.
7. Insert the ignition key.
8. Start the vehicle by turning the ignition key to the ON position.



9. Press D-switch.



10. Brake with both brake handles simultaneously to activate the vehicle.



11. Select direction with the forward/reverse switch.
12. Release the brake handle.
13. Slowly turn the throttle.

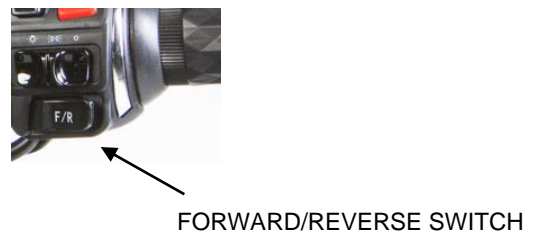

14. Be ready to press the brake handle, if necessary.



3.2.2 STOPPING AND SWITCHING OFF THE VEHICLE

1. Make sure the vehicle is parked in a safe and level location.
2. Ensure the wheels are turned in desired direction and not towards a downhill incline.
3. Place the Forward/Reverse switch in the desired position.
4. Activate the EPB by pushing the P-switch.
(to check if it's activated try to move the vehicle by pushing/pulling).



5. Switch off by turning the ignition key counterclockwise.
6. Remove the key.
7. Turn off the main switch.

3.2.3 HOW TO OPERATE THE VEHICLE WHILE DRIVING

1. Use the handle bar to control the direction of the ride.
2. Use throttle to control the speed.
3. Use either of the brake handles to reduce speed and to stop the vehicle.

3.4 RECHARGING INSTRUCTIONS

Connect the charger cable to the ELLWEE receptacle.

Insert the charger cable in the wall socket.

Charge the batteries for 4.5 hours after a full day use or until the lighting on charger device is green.

Disconnect the charger cable in opposite order when the batteries are fully recharged or when recharging is not necessary.

Read the Charger Instruction Manual for more information.